

Installation guide: Peel and stick mat

HaptixTM BY
CMT
GROUP

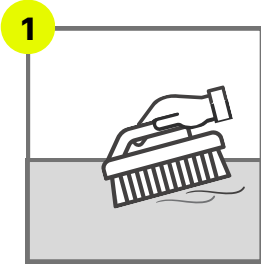

Thoroughly clean selected area before installation. Any dust or debris can reduce the effectiveness of the adhesive.

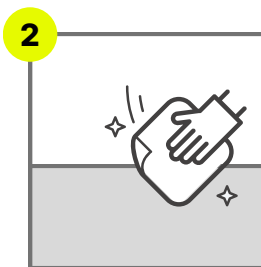

Ensure surface is completely dry before installation.

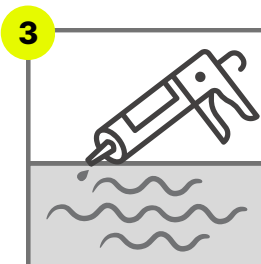

Apply Sika Dur 31 as a thinly spread layer or Hilti RE100 adhesive in this zigzags directly to surface. Make sure the full area for the mats is covered.

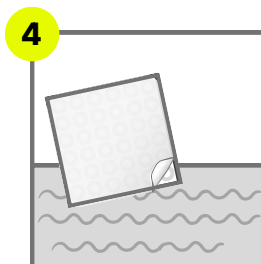

Peel film from the back of your tactile mat to expose the sticker back. Be sure not to allow anything to adhere to the mat prior to installation.

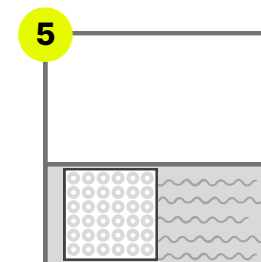

Line mat up with your desired location, ensuring the adhesive is evenly distributed along the mats under side. Press firmly onto the surface and allow to dry for four hours.